

TERM. NO.'s FOR REF. ONLY

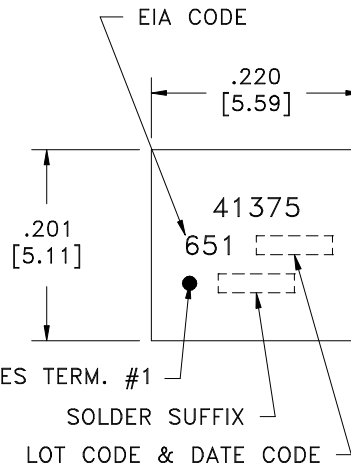
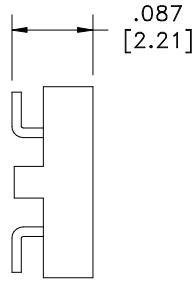
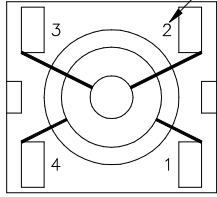

DOT LOCATES TERM. #1

SOLDER SUFFIX

LOT CODE & DATE CODE

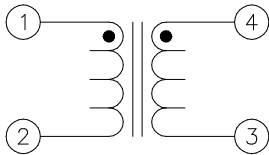

AREA REPRESENTS
TERMINAL PAD DIMENSIONS

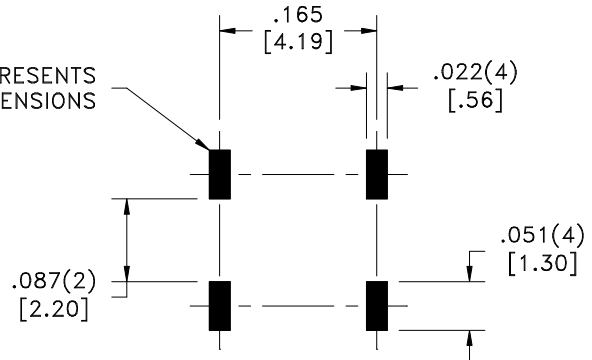

CUSTOMER TO DETERMINE LAND LAYOUT

ELECTRICAL SPECIFICATIONS @ 25°C unless otherwise noted:

- ⑥C D.C. RESISTANCE (@20°C): 1-2, 0.20 ohms max.
4-3, 0.20 ohms max.
- DIELECTRIC RATING: 1500VAC, 1 minute tested by applying 1875VAC for 1 second between 1-4.
- ⑥B INDUCTANCE: 157uH ±30%, 100kHz, 10mVAC, 1-2, Ls.
- URNS RATIO: (1-2):(4-3) = 1:1, ±1%.
- COMMON MODE ATTENUATION: -18dB typ., 100kHz.
-30dB typ., 2MHz.
-35dB typ., 30MHz.

DETAILS SUBJECT TO CHANGE

Unless otherwise specified:
Tolerances:
Angles: ±1°
Fractions: ±1/64
Decimals: ±.005[.13]

This drawing is dual dimensioned.
Dimensions in brackets are in millimeters.

DRAWING TITLE

INDUCTOR

eiSos p/n: 750041375

SEE REVISION SHEET FOR REVISION LEVEL



PART NO.

41375R-LF1

REV.

6C
11/10

SPECIFICATION SHEET 1 OF 1

PART #
41375R-LF1