

PART MUST INSERT FULLY TO SURFACE A IN RECOMMENDED GRID

* DIMENSION MAY BE EXCEEDED WITH SOLDER ONLY

.021 SQ.(10)
[.53]

.110/.130 *
[2.79/3.30]

.500 MAX.
[12.70]

.550 MAX.
[13.97]

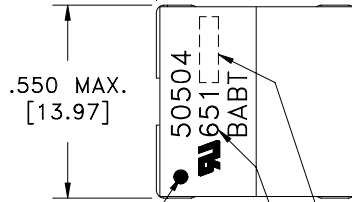
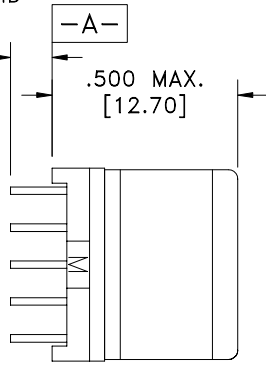
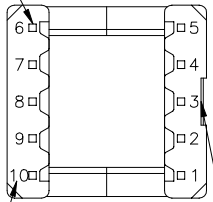

TERM. NO.'s FOR REF. ONLY

NOTCH LOCATES TERM. 1-5 SIDE

DOT LOCATES TERM. #1

EIA CODE

LOT CODE & DATE CODE

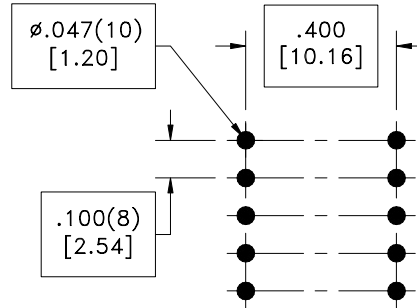
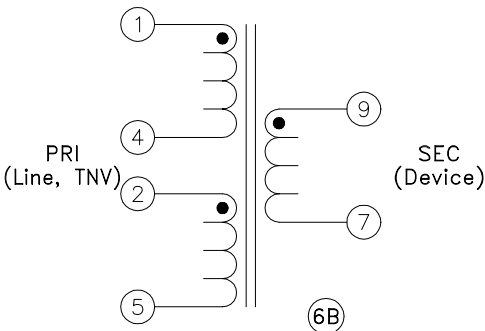

RECOMMENDED P.C. PATTERN, COMPONENT SIDE

ELECTRICAL SPECIFICATIONS @ 25°C unless otherwise noted:

- IMPEDANCE: Designed to reflect 135 ohms on the PRI with 42 ohm load on SEC.
- LONGITUDINAL BALANCE: 53dB min., 500-292kHz, per FCC part 68.310, with terminal 7 grounded.
- D.C. RESISTANCE (@20°C):
 9-7, 3.23 ohms ±10%
 1-4, 3.46 ohms ±10%
 2-5, 3.46 ohms ±10%
- DIELECTRIC RATING: 1500VAC, 1 minute tested by applying 1875VAC for 1 second between 9-1; 9-5.
- INDUCTANCE: 600uH ±5%, 10kHz, 1.0VAC, 9-7, Ls.
- LEAKAGE INDUCTANCE: 20uH max., 100kHz, 100mVAC, 9-7(tie 2+4, 1+5), Ls.
- 6B TURNS RATIO: (1-5):(9-7) = 1.8:1, tie(2+4), ±1%.
(1-4):(2-5) = 1:1, ±1%.
- TOTAL HARMONIC DISTORTION: -84.5dB typ., 5000Hz, 1.45Vrms, 42 ohm load, 135 ohm input, tie(2+4).
- INTERWINDING CAPACITANCE: 75pF max., 100kHz, 1.0VAC, 1-9(tie 2+4), Cs.
- OPERATING TEMPERATURE RANGE: -40°C to +85°C.

Designed for use with Level One: SK70704/SK70707

Designed to comply with the following requirements as defined by IEC60950, EN60950, UL60950/CSA60950 and AS/NZS60950:

- Supplementary insulation for a primary circuit at a working voltage of 250Vrms.

6B 6E	
AGENCY NUMBER	
6D	BAPT NC/012203
6D 6C	UL 60950 E205930
6D 6C	CSA 60950 (Via CUL) E205930
	IEC 60950 (Via CB cert.) US/8104/UL
	ACA/AUSTEL (Via CB cert.) US/8104/UL
	JAPAN (Via CB cert.) US/8104/UL

Midcom, Inc.
 Watertown, SD USA
 Toll Free: 800-643-2661
 Fax: 605-886-4486

Unless otherwise specified:
 Tolerances: Fractions: ±1/64
 Angles: ±1° Decimals: ±.005[.13]

DRAWING TITLE
TRANSFORMER

Midcom

DRAWING NO.

50504

REV.

6E
8/04

REVISIONS: SEE SHEET 1

SCALE ---

SHEET 2 OF 6

This drawing is dual dimensioned.
 Dimensions in brackets are in millimeters.

DWG # 50504