

PART MUST INSERT FULLY TO SURFACE A IN RECOMMENDED GRID

* DIMENSION MAY BE EXCEEDED WITH SOLDER ONLY

.021 SQ.(10)
[.53]

.110/.130 *
[2.79/3.30]

.500 MAX.
[12.70]

.550 MAX.
[13.97]

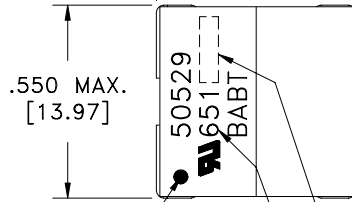
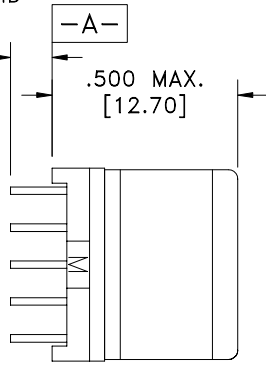
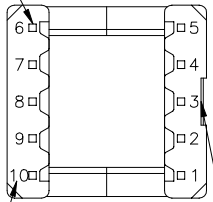

TERM. NO.'s FOR REF. ONLY

NOTCH LOCATES TERM. 1-5 SIDE

DOT LOCATES TERM. #1

EIA CODE

LOT CODE & DATE CODE

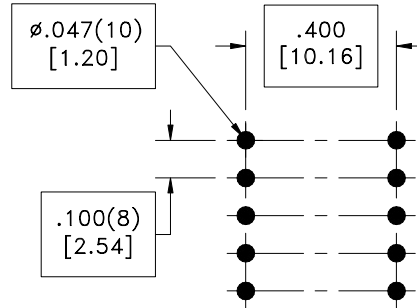
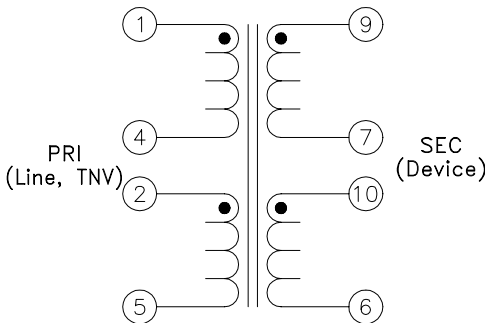

RECOMMENDED P.C. PATTERN, COMPONENT SIDE

ELECTRICAL SPECIFICATIONS @ 25°C unless otherwise noted:

- LONGITUDINAL BALANCE: 60dB min., 35k-650kHz, per FCC part 68.310, with term. 9 or 7 grounded.
- D.C. RESISTANCE (@20°C):
 - 9-7, 0.30 ohms ±10%.
 - 1-4, 0.49 ohms ±10%.
 - 2-5, 0.49 ohms ±10%.
 - 10-6, 0.89 ohms ±10%.
- INSERTION LOSS: 0.5dB max., at 100k, 12.6 ohm load.
- DIELECTRIC RATING: 1500VAC, 1 minute tested by applying 1875VAC for 1 second between PRI-SEC.
- INDUCTANCE: 55uH ±10%, 10kHz, 100mVAC, 9-7, Ls.
- LEAKAGE INDUCTANCE: 0.5uH typ., 100kHz, 100mA, 9-7(tie 2+4, 1+5), Ls. 8uH typ., 100kHz, 100mA, 10-6(tie 2+4, 1+5), Ls.
- TURNS RATIO:
 - (1-4):(9-7) = 1.444:1, ±1%.
 - (2-5):(1-4) = 1:1, ±1%.
 - (10-6):(9-7) = 2.888:1, ±1%.
- TOTAL HARMONIC DISTORTION: -80dB max., 100kHz, 15Vp-p, 12.6 ohm load, 100 ohm input, tie(2+4).

AGENCY NUMBER	
BABT	NC/012203
UL 60950	E205930
CSA 60950 (Via CUL)	E205930
IEC 60950 (Via CB cert.)	US/8104/UL
ACA/AUSTEL (Via CB cert.)	US/8104/UL
JAPAN (Via CB cert.)	US/8104/UL

Designed to comply with the following requirements as defined by IEC60950, EN60950, UL60950/CSA60950 and AS/NZS60950:
 - Supplementary insulation for a primary circuit at a working voltage of 250Vrms.

Midcom, Inc.
 Watertown, SD USA
 Toll Free: 800-643-2661
 Fax: 605-886-4486

Unless otherwise specified:
 Tolerances: Fractions: ±1/64
 Angles: ±1° Decimals: ±.005[.13]

DRAWING TITLE
TRANSFORMER

Midcom

DRAWING NO. **50529** REV. 6F
 8/04

REVISIONS: SEE SHEET 1

SCALE --- SHEET 2 OF 6

This drawing is dual dimensioned.
 Dimensions in brackets are in millimeters.

DWG.# 50529