

SOLDER SUFFIX	CUSTOMER TERMINAL	RoHS	LEAD(Pb)-FREE	(6B)
	Sn63%, Pb37%	No	No	
LF1	Sn96%, Ag4%	Yes	Yes	

PART MUST INSERT FULLY TO SURFACE A IN RECOMMENDED GRID
 $\phi.031(4)$
 $[\.80]$

* DIMENSION MAY BE EXCEEDED WITH SOLDER ONLY

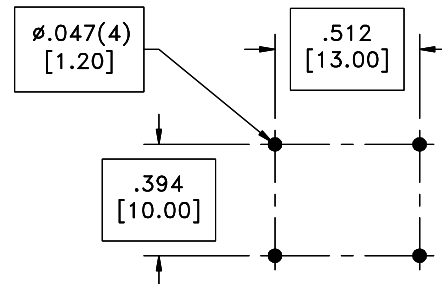
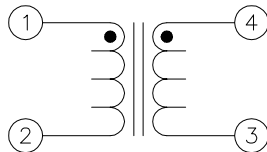
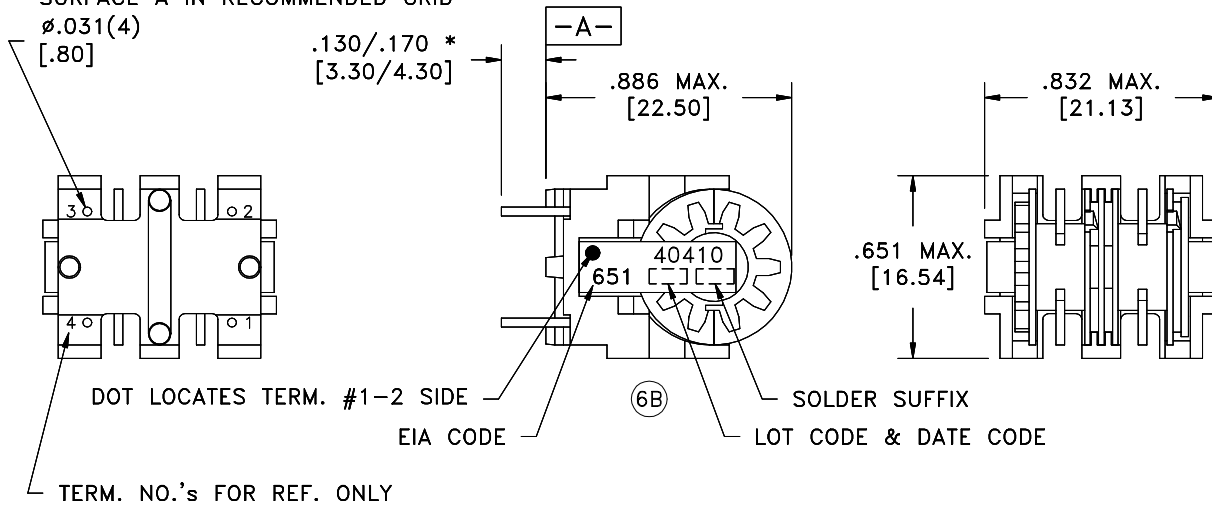

RECOMMENDED
P.C. PATTERN, COMPONENT SIDE

ELECTRICAL SPECIFICATIONS @ 25°C unless otherwise noted:

- D.C. RESISTANCE (@20°C): 1-2, 0.187 ohms $\pm 15\%$.
4-3, 0.187 ohms $\pm 15\%$.
- DIELECTRIC RATING: 2000VAC, 1 minute tested by applying 2500VAC for 1 second between 1-4; 1-core; 4-core.
- INDUCTANCE: 2.70mH min., 10kHz, 100mVAC, 1-2 Ls.
2.70mH min., 10kHz, 100mVAC, 4-3 Ls.
- TURNS RATIO: (4-3):(1-2) = 1:1, $\pm 1\%$.
- D.C. CURRENT: 1.2A continuous current based on maximum delta T of 40°C from 25°C.
- OPERATING TEMPERATURE RANGE: -25°C to +115°C.

DETAILS SUBJECT TO CHANGE

Unless otherwise specified:
Tolerances:
Angles: $\pm 1^\circ$
Fractions: $\pm 1/64$
Decimals: $\pm .005[.13]$

DRAWING TITLE

INDUCTOR

eiSos p/n:

REVISIONS: SEE SHEET 1

 Midcom
www.midcom-inc.com

DRAWING NO.

40410/-LF1

SCALE ---

REV. (6B)

3/07

SHEET 2 OF 5

DWG.# 40410/-LF1

This drawing is dual dimensioned.
Dimensions in brackets are in millimeters.